

Smart Bed

Don't fall off your chair!

Smart Bed System

In the Neurosurgical department at Rambam hospital patient sometimes experience confusion state due to the hospitalization. They may try to climb above the bed barrier and harm themselves.

Smart Bed system detects the climbing attempt and notifies the medical stuff.

The system consists of 3 main parts: Sensors attached to the bed, firestore database & application.



Smart Bed Hardware Configuration

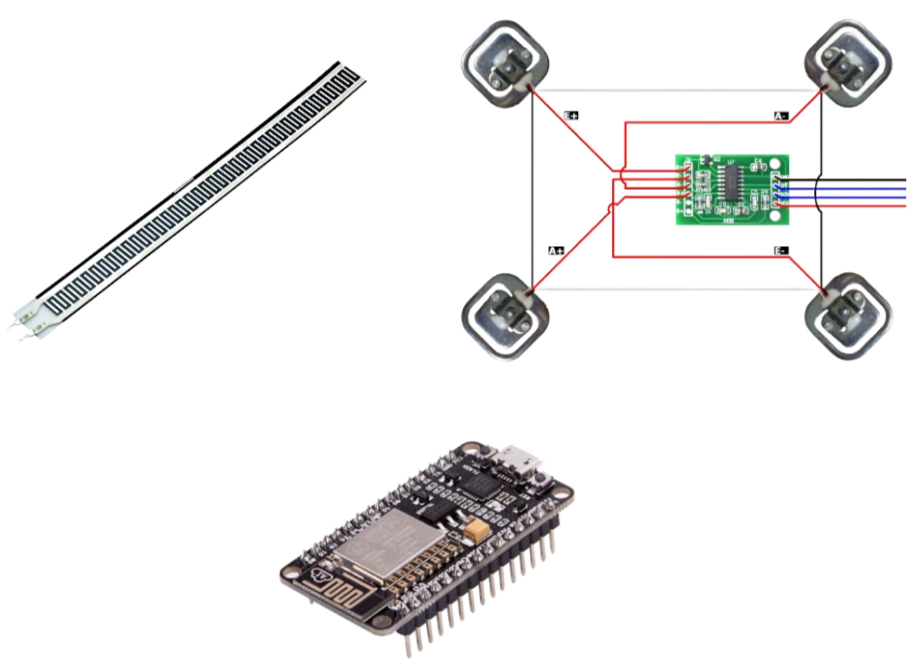

ESP32 receives data from FSR & Load Cell sensors



FSR mounting

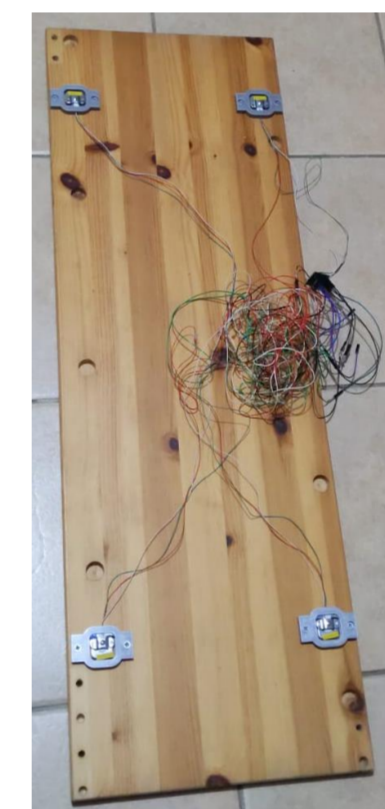

Load cell mounting

Smart Bed Application

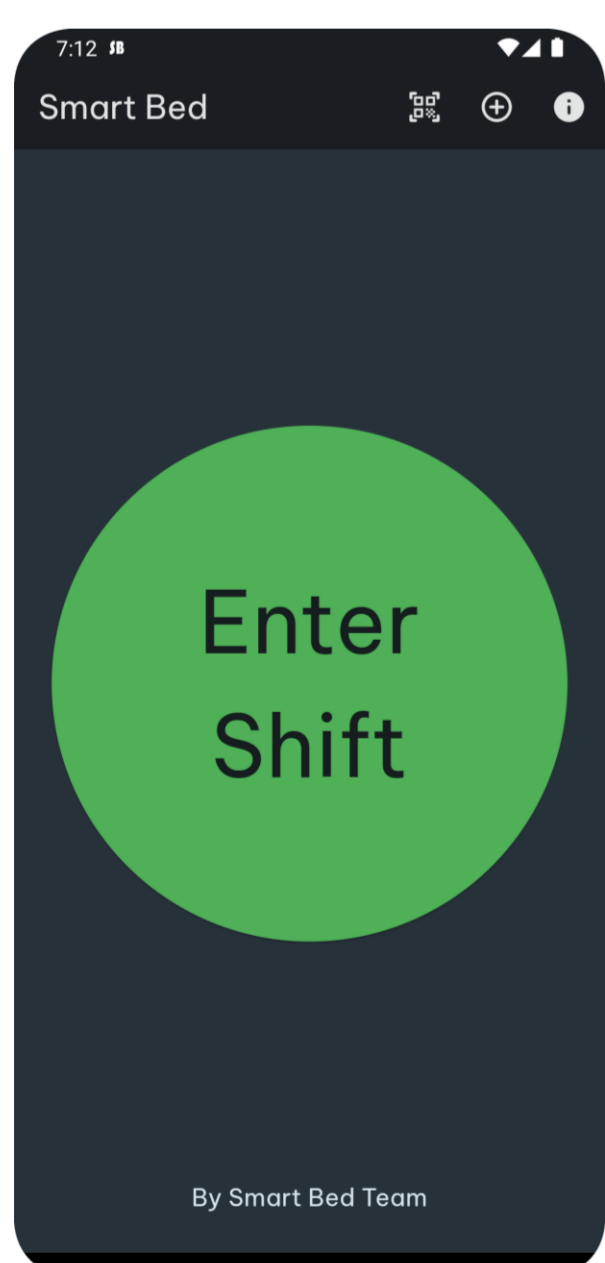

Press to start shift

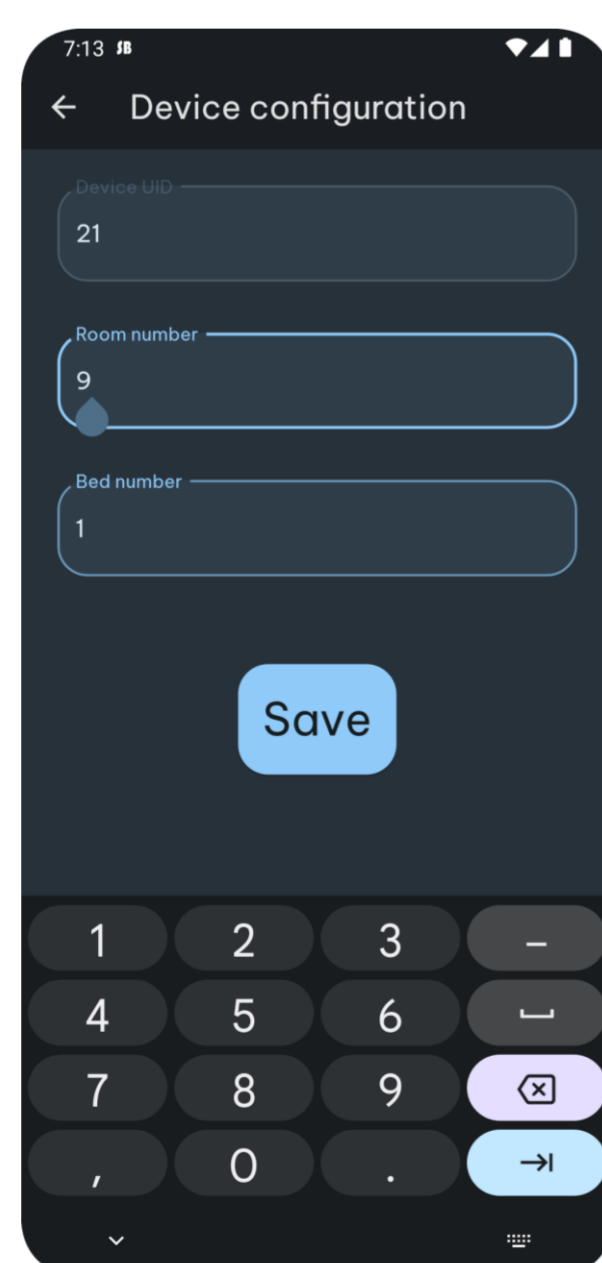

Alert specifying room & bed number

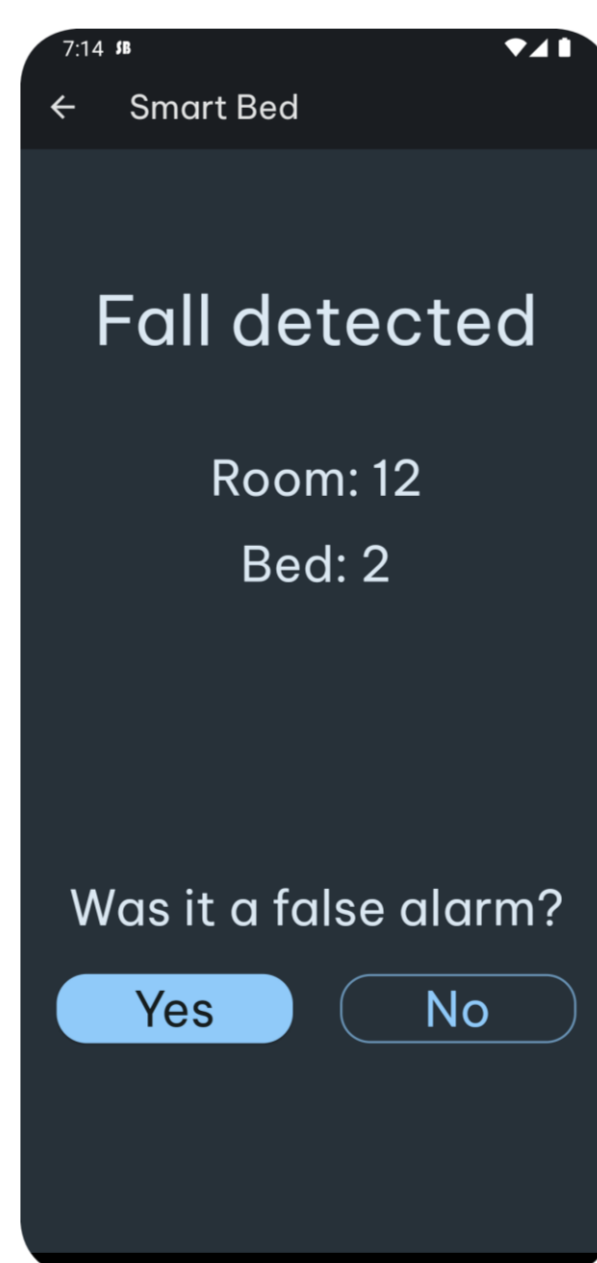

Configure device

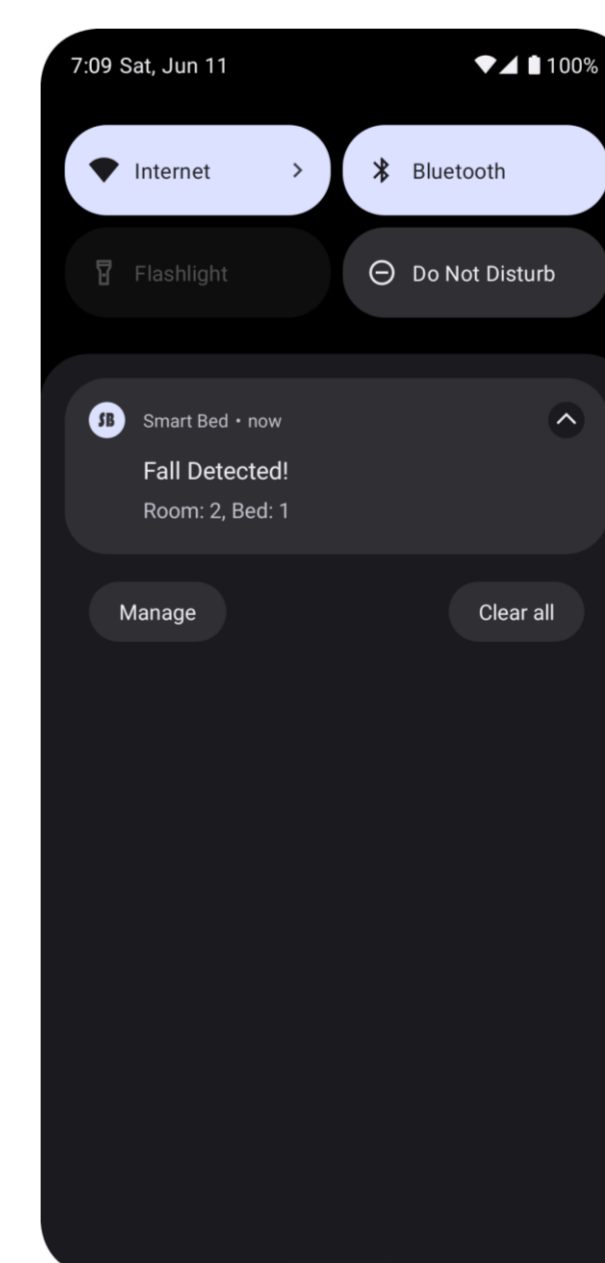

Push Notification

Team

Leon Kosarev, Tomer Ron, Elinor Ginzburg

Instructors

Mr. Itai Dabran, Mr. Tom Sofer, Mr. Yaron Porat