



LAB MANAGER

Manage your stations remotely and conveniently

Effortlessly setup multiple stations, manage accessibility with friendly application and lastly keep track of every usage in real time.

Lab Manager ensures that only qualified operators can use your devices and log each operation.

Features:

- Add a station to your lab with short simple steps.
- Operate station with card scan only!
- All in one multiple cross platform application.

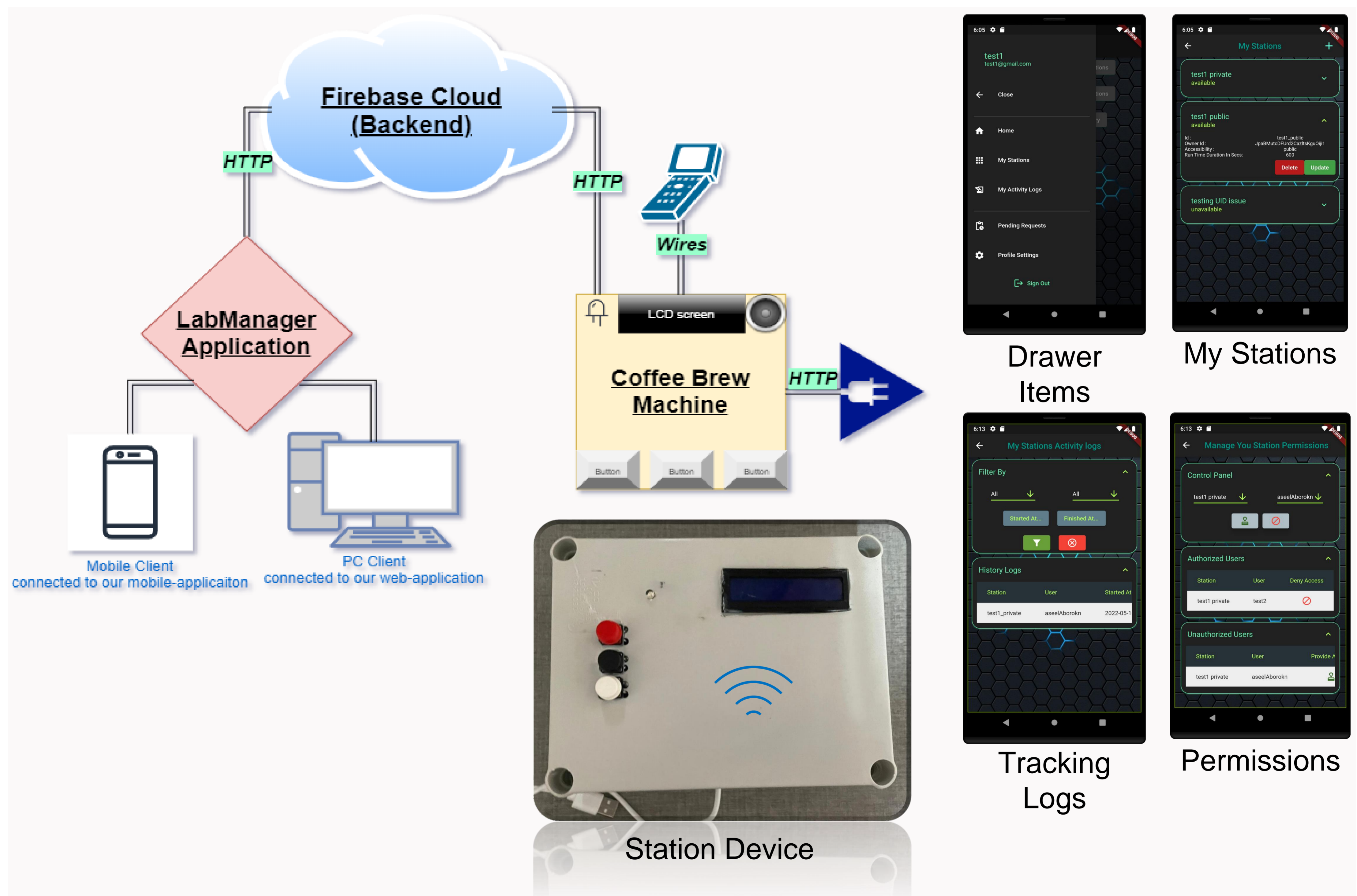

Assel Abo Rokn, Lara Kinan, Sivan Mulla
Tom Sofer, Yaron Porat

A Project in Internet of Things (IoT)